

IGNITE

Angel Estrada

+

Simran Maredia

We chose to base our design off of personal issues and the emotional roller-coaster that the entire world has been going through. We read over the poem, “The Burning” and we loved how it explored emotions at a deeper and intense level. We want our design to express intensity and serve as a reminder of the emotions we all felt on a personal level throughout 2020. We incorporated arches into the design, inspired by Gothic Architecture, because of how it evokes emotions. We also utilized lighting and shadows as a way to bring more depth and intensity into our design.

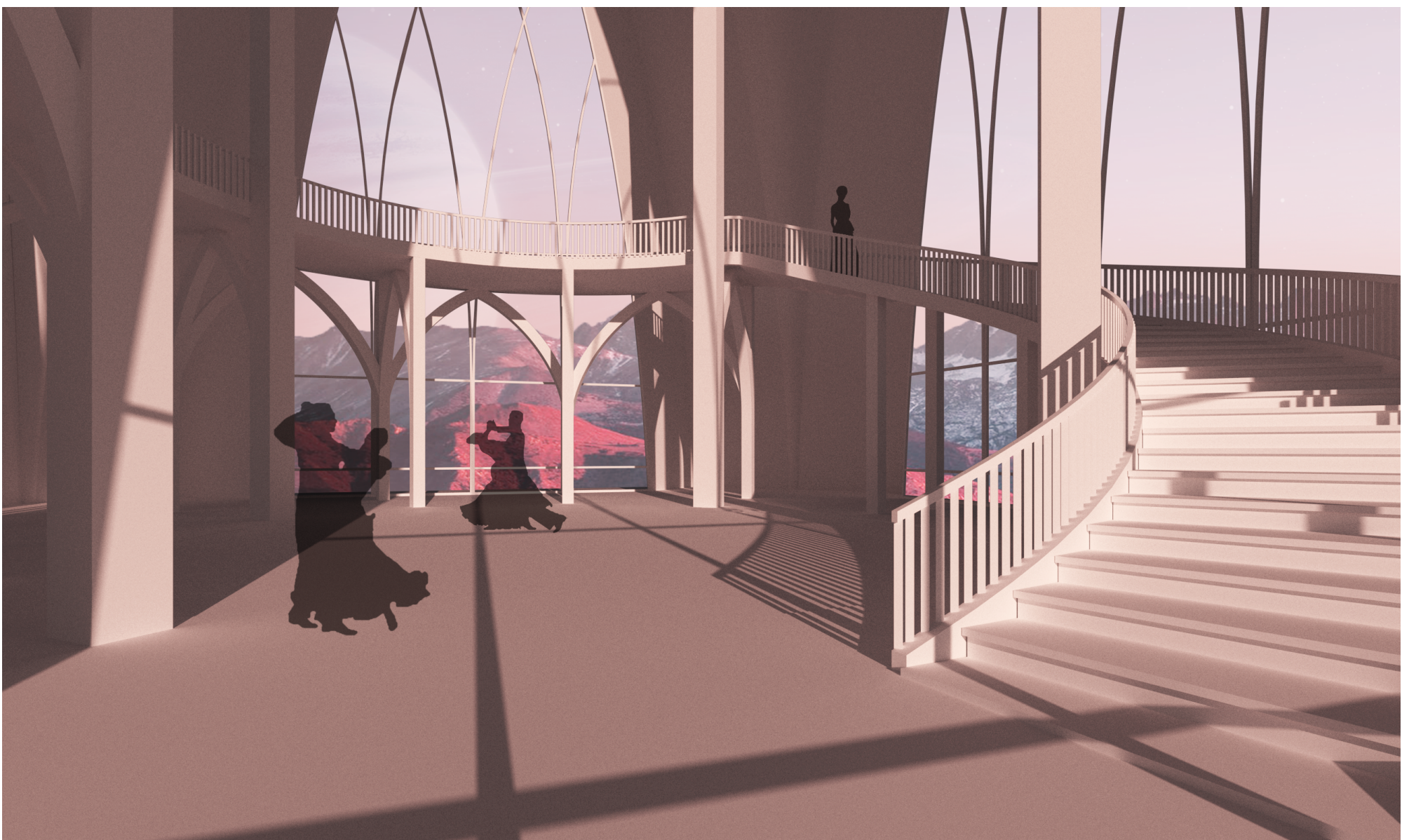
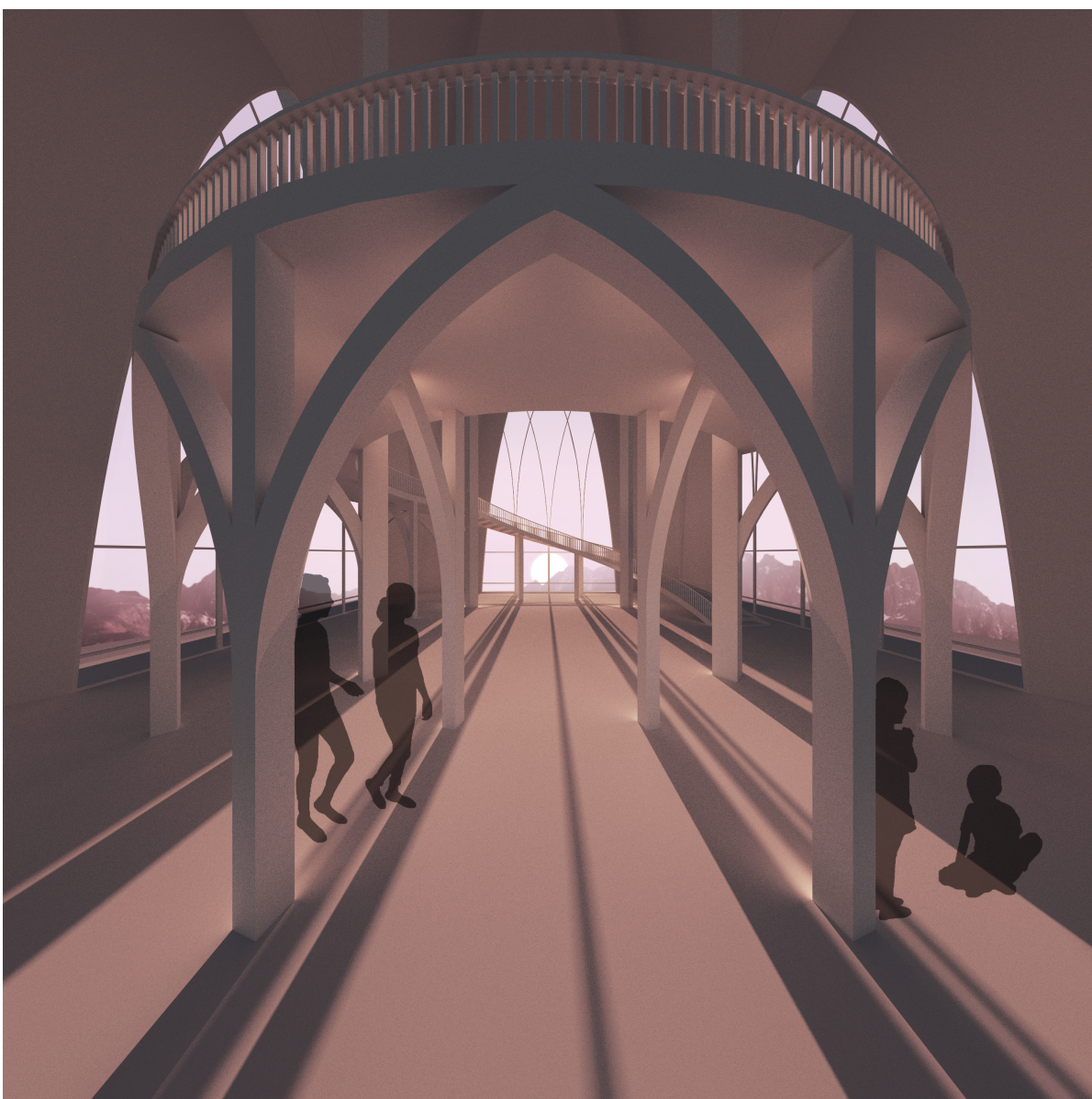
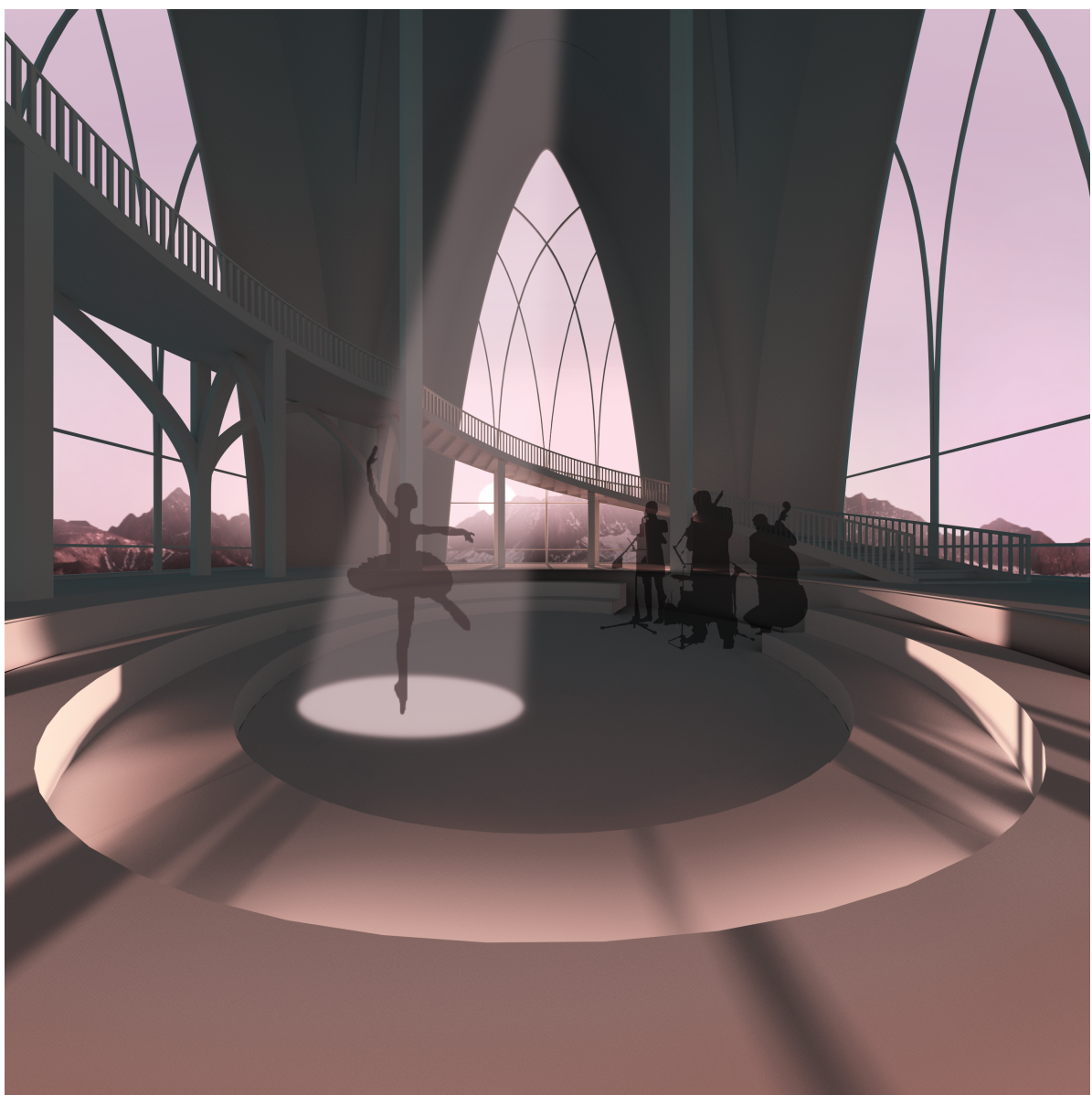

Stage + Seating Diagram

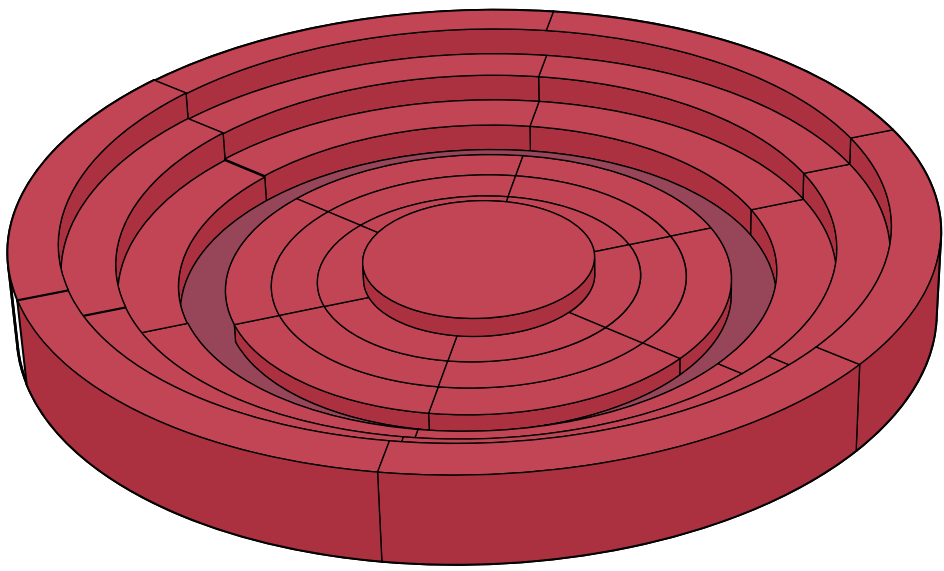

single performance

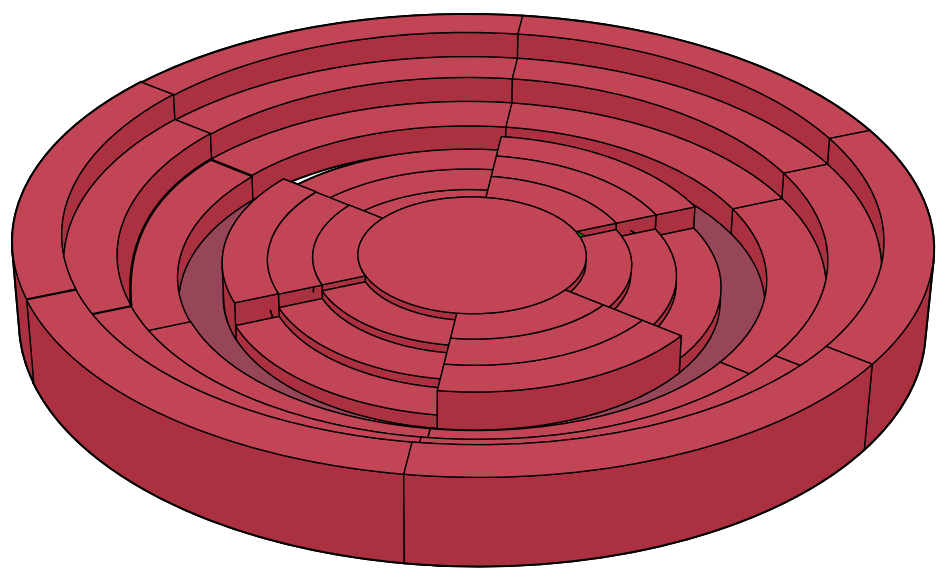

group performance

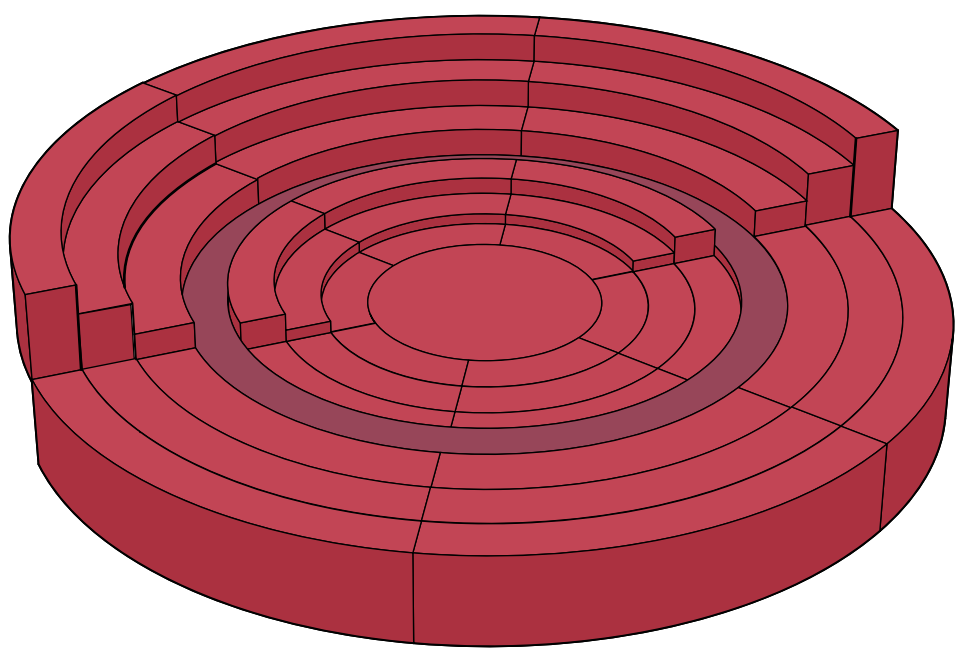

orchestra setting

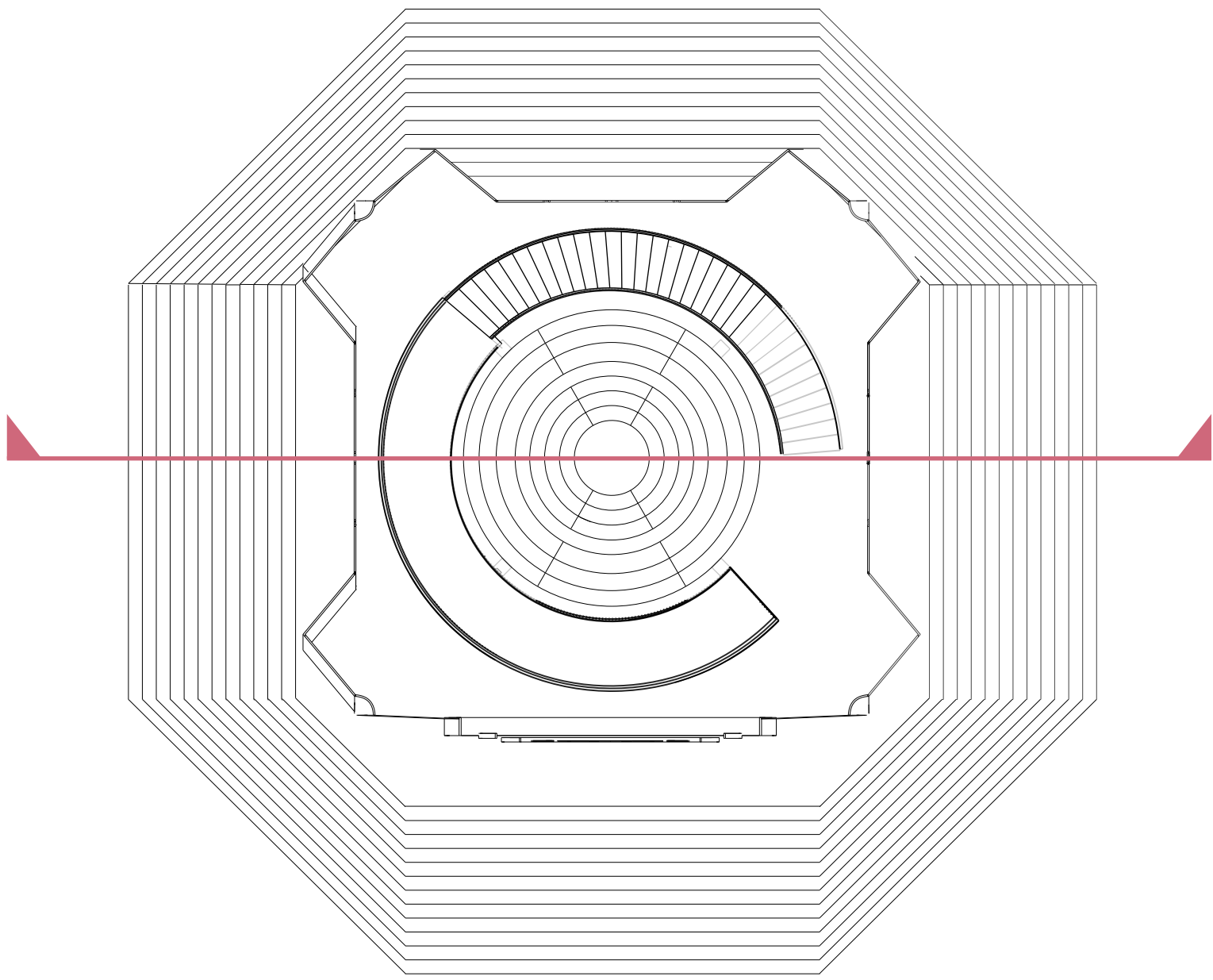

2nd Level

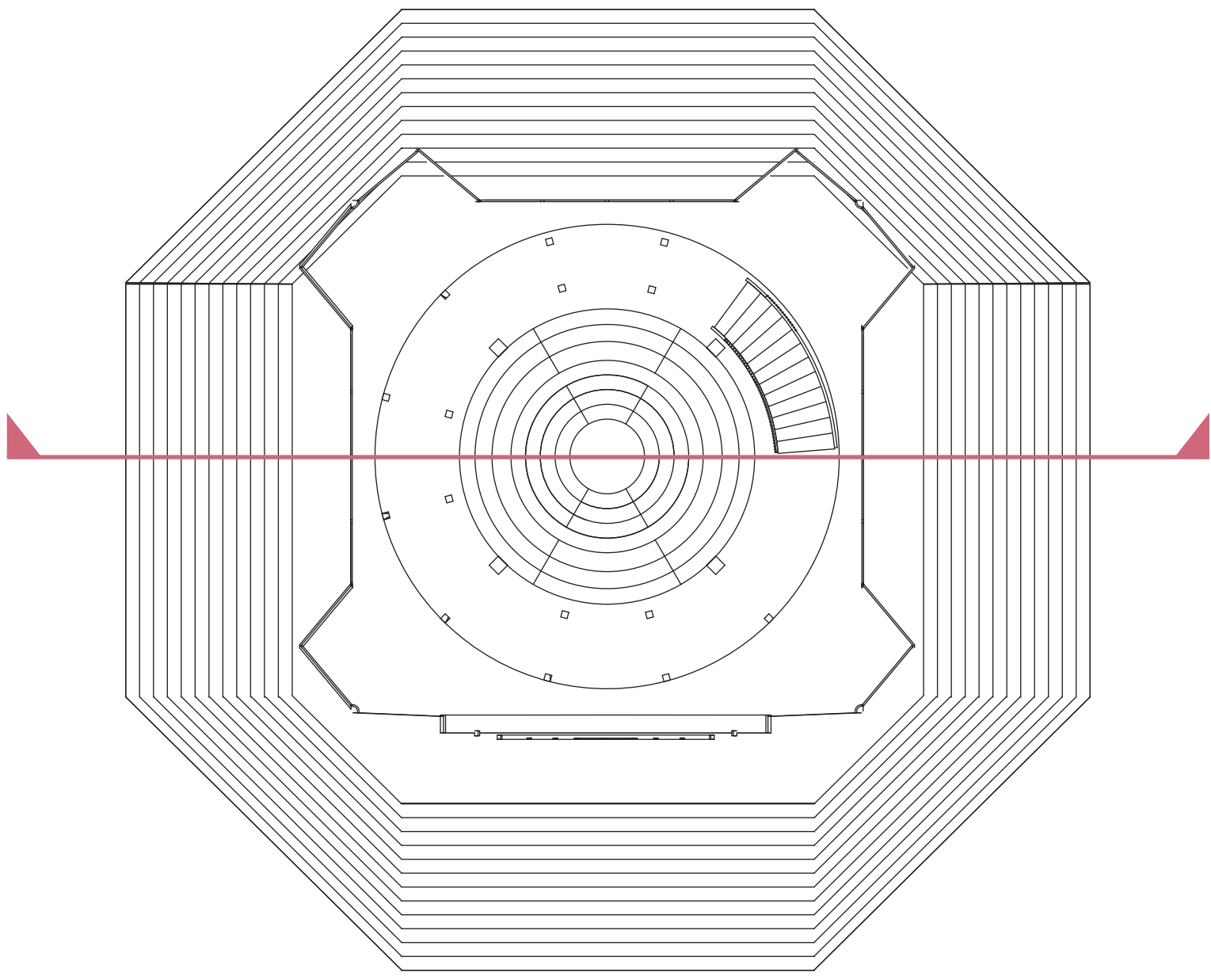

1st Level

The stage and seating is designed in a way that can be altered according to preference. Taking the concept of the ampitheater, we saw how simple yet versatile it can be adding the flexibility feature of moving components up and down to define the seating and stage. How can this space cater to not just one specific program but to all types of programs?

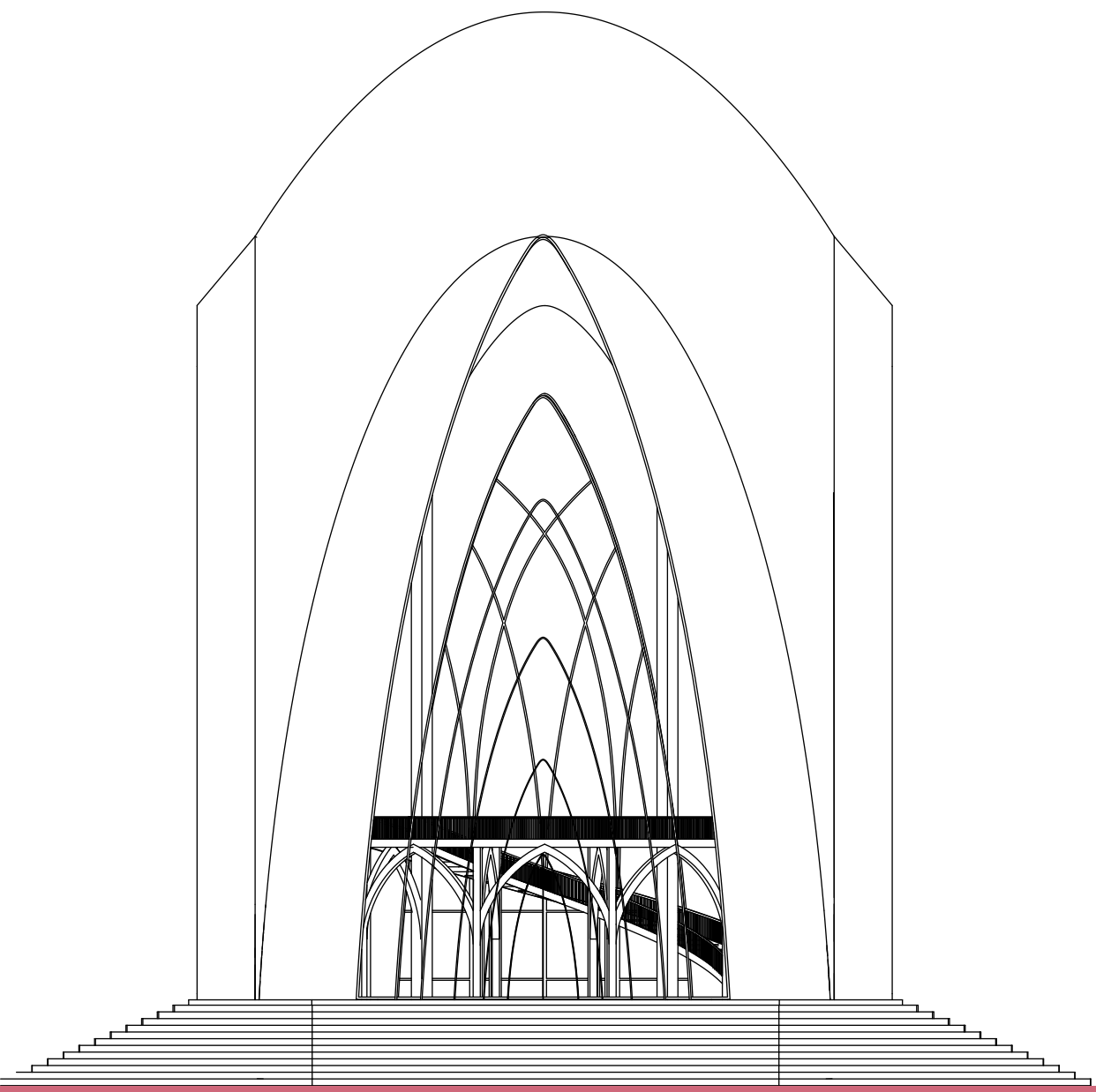

Elevation 1

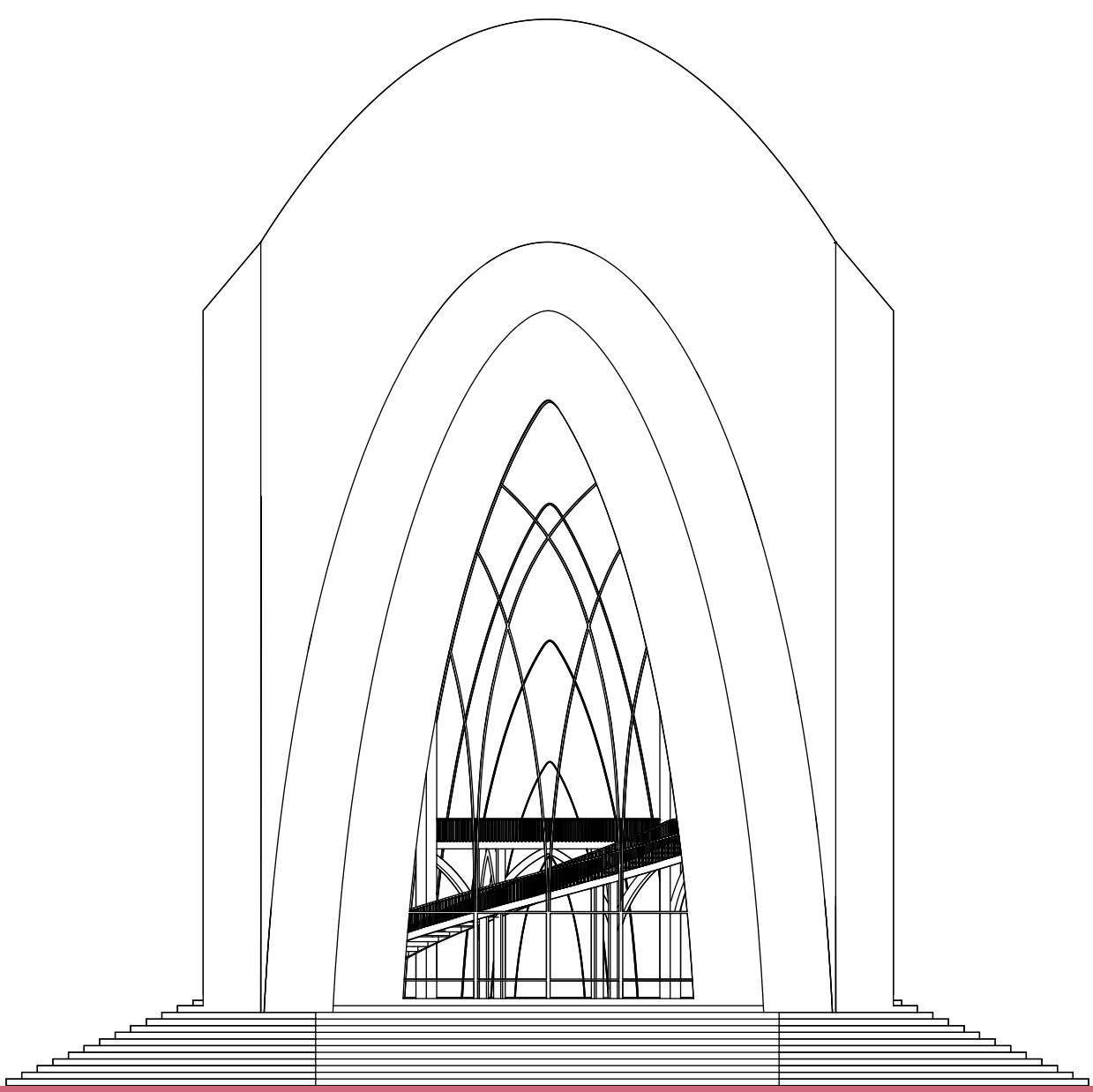

Elevation 2

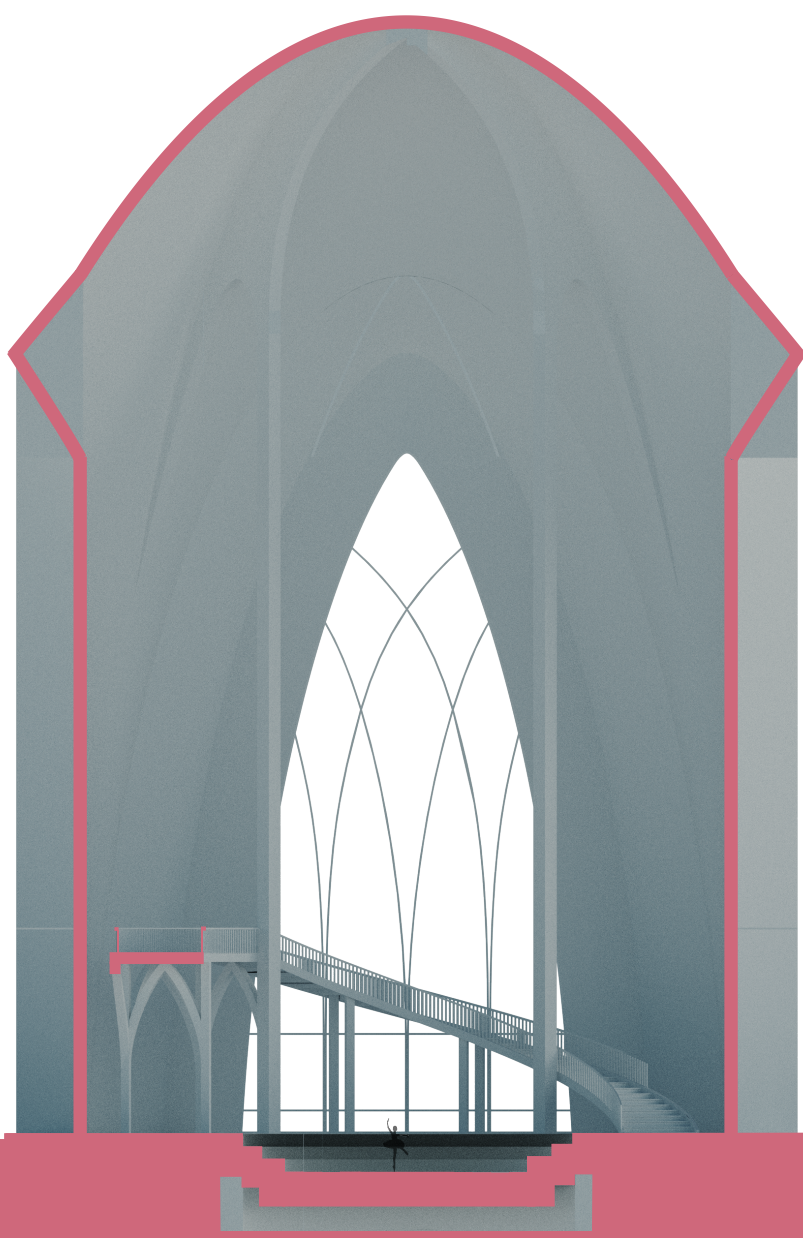

Section