

---

# Archaeological Survey for the Proposed St. Peter-St. Joseph Children's Home Expansion, City of San Antonio, Bexar County, Texas

Richard B. Mahoney

*Prepared for:*  
St. Peter-St. Joseph Children's Home  
919 Mission Road  
San Antonio, Texas



©2004

*Prepared by:*  
Center for Archaeological Research  
The University of Texas at San Antonio  
Archaeological Survey Report, No. 342

---

# Archaeological Survey for the Proposed St. Peter-St. Joseph Children's Home Expansion, City of San Antonio, Bexar County, Texas

Richard B. Mahoney

Steve A. Tomka  
Principal Investigator

*Prepared for:*  
St. Peter-St. Joseph Children's Home  
919 Mission Road  
San Antonio, Texas



©2004

*Prepared by:*  
Center for Archaeological Research  
The University of Texas at San Antonio  
Archaeological Survey Report, No. 342

A list of publications offered by the Center for Archaeological Research is available. Call (210) 458-4378; write to the Center for Archaeological Research, The University of Texas at San Antonio, 6900 N. Loop 1604 W., San Antonio, Texas 78249-0658; e-mail to [car@lonestar.utsa.edu](mailto:car@lonestar.utsa.edu); or visit CAR's web site at <http://car.utsa.edu>.

## **Abstract:**

During September 2003, the Center for Archaeological Research of The University of Texas at San Antonio conducted an archaeological survey for the proposed development of 3.17 acres at the St. Peter-St. Joseph Children's Home in the city of San Antonio, Bexar County, Texas. The Phase I survey consisted of the excavation of 18 shovel tests. A single previously unrecorded prehistoric archaeological site (41BX1570) was encountered atop a terrace along a probable remnant channel of the San Antonio River. Moderate to abundant amounts of burned limestone, burned chert, and lithic debitage, along with two lithic tools comprised the prehistoric artifact assemblage. Four mechanically chipped lithic flakes were encountered with the prehistoric deposits throughout the vertical column to the terminal excavation depth of 70 centimeters below surface. The presence of these modern artifacts in concert with evidence of significant historic subsurface disturbance has provided adequate data to determine this site is not eligible for inclusion on the National Register of Historic Places nor for listing as a State Archeological Landmark. It is therefore recommended that the proposed improvements proceed without further cultural resources investigations. All collected artifacts and records are curated at the Center for Archaeological Research permanent storage facility.

## Table of Contents:

Abstract .....	i
Figures .....	iii
Tables .....	iii
Acknowledgments .....	iv
Chapter 1: Introduction .....	1
Project Overview .....	1
Report Layout .....	1
Chapter 2: Environmental Setting .....	3
Weather, Flora, and Fauna .....	3
Geology and Geomorphology .....	3
Chapter 3: Archaeological Background .....	5
Cultural Setting .....	5
Previous Investigations .....	7
Chapter 4: Methodology .....	9
Literature Review .....	9
Field Methods .....	9
Laboratory Methods .....	9
Chapter 5: Results .....	11
Literature Review .....	11
Fieldwork .....	14
Chapter 6: Summary .....	17
References Cited .....	18
Appendix A: Artifact Catalog .....	21

## Figures:

Figure 1-1. General location of project area. ....	1
Figure 1-2. Current St. PJ's campus with proposed construction areas. ....	2
Figure 2-1. Project area in relationship to Natural Regions of Texas. ....	3
Figure 2-2. Map of the San Antonio River in proximity to the project area. ....	4
Figure 5-1. Early photograph of St. PJ's depicting dormitory locations. ....	11
Figure 5-2. Tobin® aerial photograph of the campus probably taken during the late 1960s. ....	12
Figure 5-3. Overlay of 1960s Tobin® aerial with the modern footprint of St. PJ's campus. ....	13
Figure 5-4. Distribution of shovel tests excavated during September 2003. ....	14
Figure 5-5. Vertical distribution of burned chert and debitage by count. ....	15
Figure 5-6. Vertical distribution of burned chert and debitage by percentage. ....	16

## Tables:

Table 5-1. Vertical distribution by count. ....	16
Table 5-3. Horizontal distribution of prehistoric artifacts. ....	16
Table 5-2. Vertical distribution by percent. ....	16
Table A-1. Artifact catalog of September 2003 shovel test excavations at St. PJ's. ....	22

## Acknowledgments:

Several individuals have contributed to the successful completion of this project. The Center for Archaeological Research (CAR) would like to thank Lee Bright of Chesney-Morales & Associates, Inc., for facilitating CAR throughout the project. Dr. Susan Bomalaski, Executive Director of St. Peter-St. Joseph Children's Home, was also helpful with regard to scheduling the field efforts. The field crew consisted of Leonard Kemp, Cindy Muñoz, and the author. Rebecca Galdeano conducted laboratory processing and inventory. Anne Fox and Wayne Cox, CAR archaeologists, contributed valuable information on the local archaeology of the project area. Steve Tomka, CAR Director, provided technical advice. Bruce Moses and Richard Young, CAR draftsmen, produced the figures in this report. Johanna Hunziker, CAR editor, produced the final version this report.

## Chapter 1: Introduction

The Center for Archaeological Research (CAR) of The University of Texas at San Antonio was contracted by Chesney-Morales & Associates, Inc. of San Antonio to conduct an archaeological survey of the property to be included in the first stage of expansion at the St. Peter-St. Joseph Children's Home (St. PJ's) in the city of San Antonio, Bexar County, Texas (Figure 1-1). Subsurface disturbance as a result of this first stage of proposed development will impact an area of approximately 3.17 acres (1.28 ha). The purpose of the survey was to locate and identify any cultural resources that may be impacted by this proposed first stage of development. The survey was performed by CAR staff during September 2003.

The survey was performed under the guidelines of the Historic Preservation and Design Section (Article 6) of the Unified Development Code, Department of Planning, Historic Preservation Office, City of San Antonio.

### Project Overview

The proposed St. PJ's project area is located southwest of Mission Road, across said road from Mission Concepción. The project area is bound to the south and west by unimproved and improved lands bordering the channelized San Antonio River; to the northwest by National Park Service lands; to the northeast by Mission Road; and to the east and southeast by Seton Home (Figure 1-2).

Three facilities are planned for the current phase of development:

- 1) St. PJ's Counseling Center, encompassing 4,500 ft<sup>2</sup>;
- 2) St. PJ's Gymnasium, encompassing 31,500 ft<sup>2</sup>; and
- 3) St. PJ's Parking, encompassing 102,000 ft<sup>2</sup>.

Several other phases of development are proposed; however, these phases of future development are not part of the current project and will require separate cultural resources investigations.

### Report Layout

This report is comprised of six chapters and one appendix. Following this introductory chapter, Chapter 2 presents the environmental setting for the project area. Chapter 3 reviews the archaeological background for the area, including the cultural setting and previous archaeological investigations.

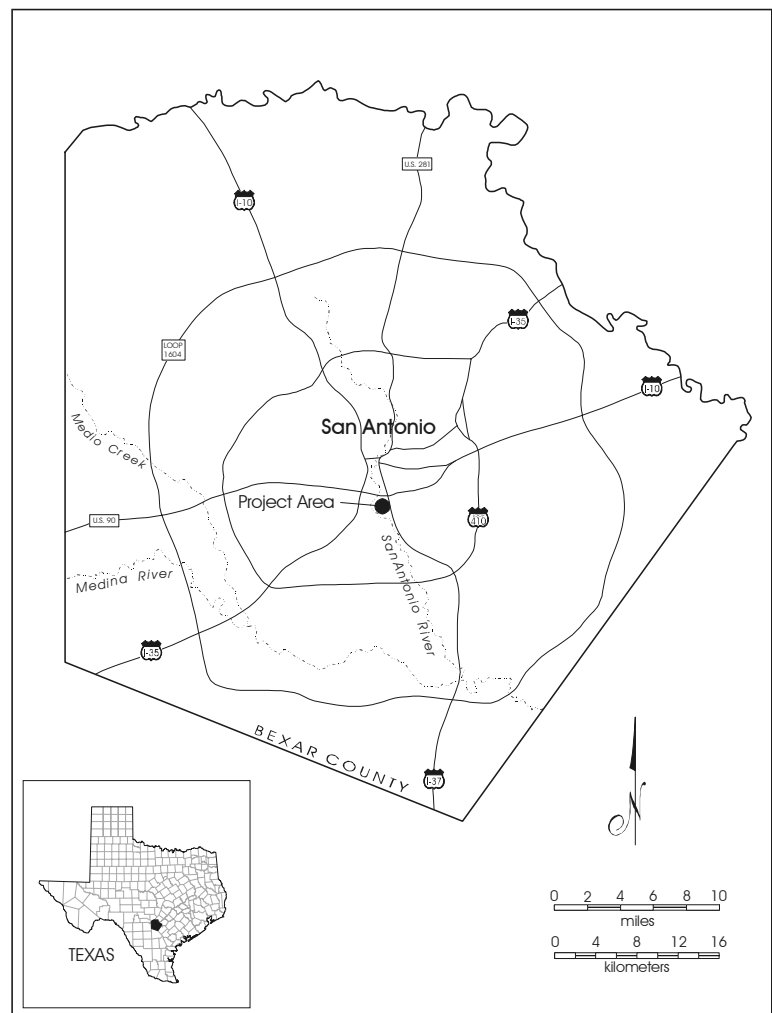

Figure 1-1. General location of project area.



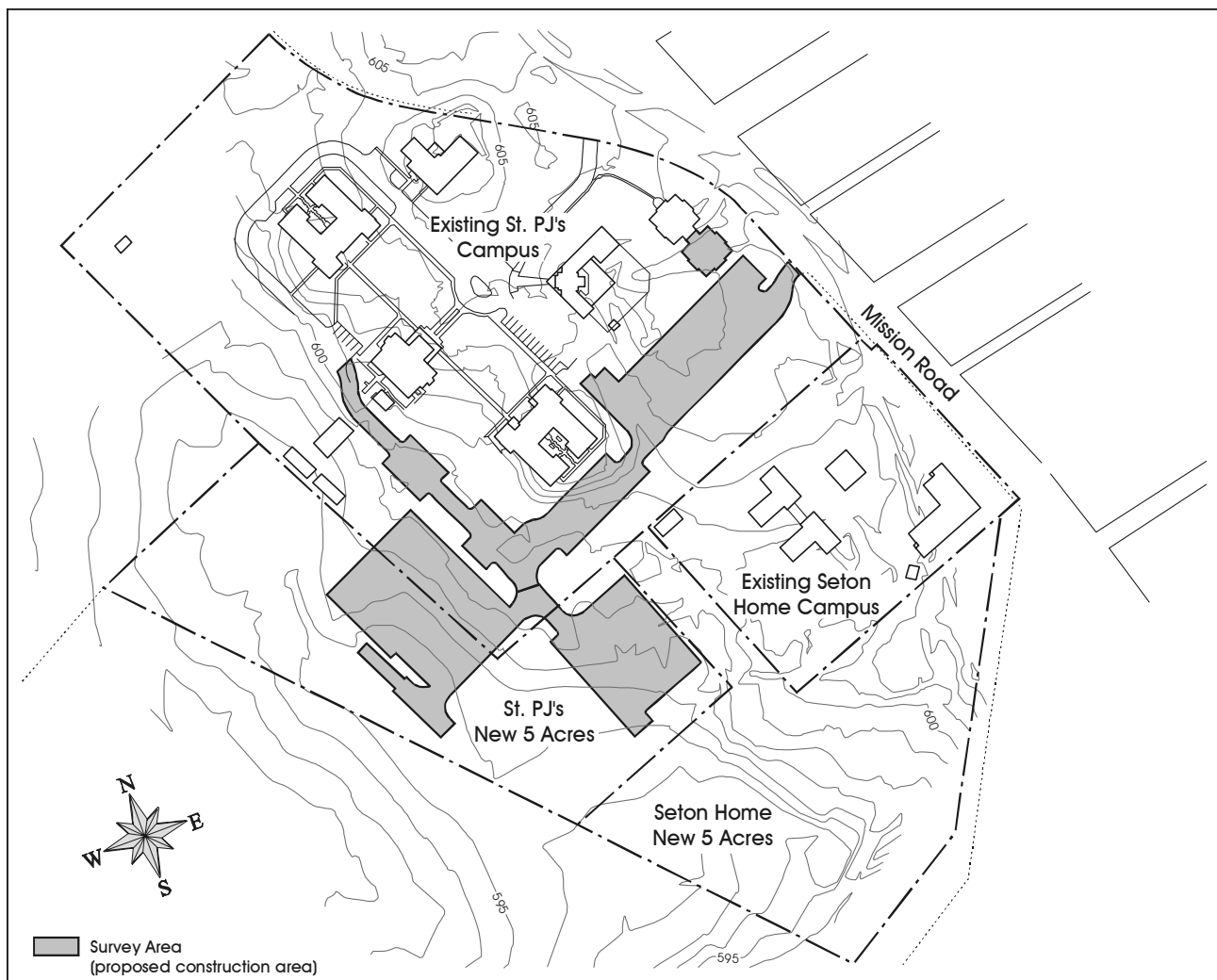

Figure 1-2. Current St. PJ's campus with proposed construction areas.

Chapter 4 discusses the methodology employed for the testing, specifically the background literature review, field methods, and laboratory methods. Chapter 5, Results, details the outcome of the archaeological fieldwork and laboratory processing. Chapter 6 summarizes the current project and offers management recommendations. The single appendix is comprised of the artifact catalog from the shovel test excavations.

## Chapter 2: Environmental Setting

As the environment of Bexar County is quite diverse, a summary of the environment specific to the immediate project area is provided to furnish a background for understanding prehistoric human adaptations to the South Texas Brush Country, Blackland Prairie, and Edwards Plateau vegetation regions (Figure 2-1).

The San Antonio River forms at the confluence of Olmos Creek with natural springs north of downtown San Antonio. Olmos Creek, in turn, heads in the Edwards Plateau region of northern Bexar County, flows through limestone bedrock formations across the Balcones Escarpment, where it empties out onto the Blackland Prairie near the confluence with the San Antonio River. The project area is situated atop an upper terrace of the San Antonio River. The river has since been channelized in this portion of its course (Figure 2-2), with the extant channel now some 250 meters (825 feet) west of its pre-channelized meander.

### Weather, Flora, and Fauna

Bexar County has a subtropical climate, with warm winters and hot summers. The average winter temperature is 58°F (14°C) and the average summer temperature is 80°F (27°C). The growing season averages around 245 days a year in the northern half of the county and 275 days a year in the southern half of the county. The prevailing winds are light (8 knots) and predominately flow from the southeast. The average annual precipitation is 31 inches (79 cm), with rainfall evenly distributed throughout the year (Taylor et al. 1991:118). Atlantic hurricanes occasionally affect the county, causing high winds and sporadic, heavy rainfall. The project area lies along the northern boundary of the Tamaulipan biotic region of South Texas, a region characterized by thorny brush, including mesquite, acacia, white brush, and prickly pear (Blair 1950:103). The northern boundary of this region is formed by the Balcones Escarpment.

Blair (1950:104) identifies the fauna of the region as diverse with numerous species of mammals, reptiles, and amphibians. Prior to urbanization, the riparian zone along the San Antonio River would have afforded a resource-rich environment for such mammals as white-tailed deer, rabbit, squirrel, raccoon, opossum, skunk, and various rodents. Similarly, reptiles, amphibians, fish, and bivalves would likely have favored such a riparian area.

### Geology and Geomorphology

The geology of Bexar County consists primarily of Mesozoic formations beginning with the Cretaceous Trinity Group in the northwest and continuing with the Eocene Claiborne Group in the extreme southeast. Quaternary undivided deposits are present in the central portion of the county, underlying the southern part of the city of San Antonio. Located within these Quaternary fluvial deposits, the project area is situated atop the Holocene alluvial deposits of the San Antonio River.

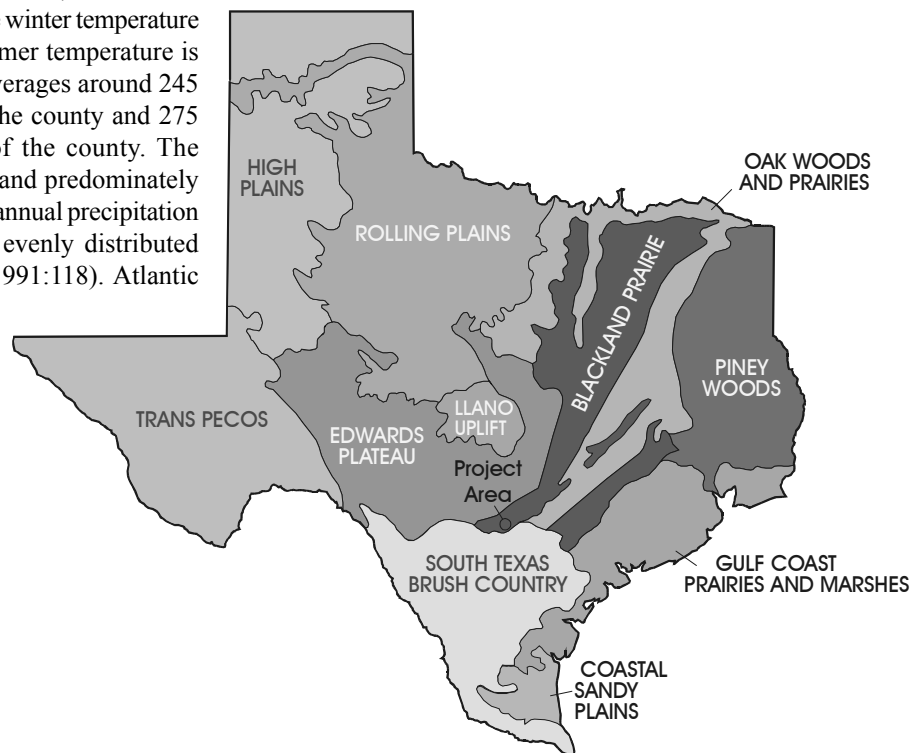

Figure 2-1. Project area in relationship to Natural Regions of Texas.



## Chapter 3: Archaeological Background

A brief overview of the prehistoric cultural setting of South Texas relative to the project area and a synopsis of previous archaeological investigations conducted in the immediate vicinity of the project area are presented in this chapter. These summaries are based, in part, on more comprehensive reviews of cultural chronologies and archaeological investigations found in Black (1989), Hester (1995), Tomka et al. (1997), and Vierra (1998).

### Cultural Setting

The chronological sequence discussed here is based on Black (1989), Collins (1995), and Hester (1995). It is intended to provide a relatively localized culture history of the project area. Most attempts to develop a culture history for South Texas have depended almost entirely on information from Central Texas, Lower Pecos, and Gulf Coast sites. This practice has been, in the past, considered acceptable because of the similarity of many artifact assemblages, especially the projectile points, over most of South Texas. An additional contributing factor was the lack of deeply stratified South Texas sites where a regional chronological sequence could be developed. A brief and generalized culture history is presented below for the South Texas archaeological region.

The formulation of a regional chronology for South Texas has received relatively little attention, perhaps due to the nature of the archaeological record in the region. Hester (1995:429) notes that most sites are open campsites, often found to be completely superficial or having very shallow artifact-bearing zones which were either very stable over thousands of years or are the result of serious erosion and deflation. Many of these sites are "occupation zones," i.e., long, narrow stretches along creek or river banks with a thin scatter of artifacts containing a wide variety of temporal diagnostics in a confusing horizontal array. While the formation of such zones is, in itself, a distinctive regional trait, the analysis of material from such sites is difficult (Hester 1995:430). The lack of buried, undisturbed, stratified sites in the region has severely limited the development of a regional chronology.

### Paleoindian (11,200–8000 BP)

The early Paleoindian period, characterized by Clovis and Folsom points, is not well understood throughout South Texas. An early Paleoindian presence in South Texas is

represented by rare finds of Clovis and Folsom points (Hall 1984; Hester 1995). Bifacial Clear Fork tools and finely flaked end scrapers are often associated with Paleoindian points (Black 1989). Many of these early Paleoindian points are found as isolated artifacts or in association with later materials (Hall 1984).

Paleoindian groups are assumed to have been small and highly mobile, focusing primarily on the exploitation of large game. However, recent research on Paleoindian materials from the Wilson-Leonard site in Central Texas (Collins 1998), and new perspectives on Paleoindian adaptations (e.g., Tankersley and Isaac 1990) suggest that the diet of these early groups may have been much broader than previously assumed. A variety of small game may have served as common sources of animal protein, at least on a seasonal basis. Similarly, the distance traveled by a group may have been, at least in some cases, much smaller than previously assumed (Tankersley and Isaac 1990).

While isolated Paleoindian projectile points are found on a variety of landforms (Hester 1995), most sites with Paleoindian materials are found on high terraces, valley margins, and upland locations (Black 1989). This pattern is similar to Paleoindian site distribution in other parts of the country, in that sites of this time period tend to be found on landforms that provide good overviews of the surrounding landscape, are centered on critical resource zones, or are found in high-productivity drainage areas (Tankersley and Isaac 1990). The existence of deeply buried Paleoindian components in alluvial contexts (Berger Bluff [41GD40]; Brown 1987) does indicate that some caution should be exercised in excluding valley bottom settings from the Paleoindian land-use system.

### Early Archaic (8000–5000 BP)

Sollberger and Hester (1972) have suggested that the shift from the Paleoindian to an Archaic tradition was gradual, and spanned nearly 3,000 years (8000–5500 BP) in central and southern Texas. Hester (1995:436), using only projectile point morphology, defined two widespread horizons for the Rio Grande Plains. These are the Early Corner-Notched (8000–5500 BP) marked by Uvalde, Martindale, and Baker point types; and the Early Basal-Notched (5500–5000 BP) characterized by Bell and Andice points. He believes that the distinctive Guadalupe biface may be associated with the former.

Early Archaic sites are usually found on terraces near water or on the hilly areas overlooking valleys (Hester 1995:439). Both in the Chaparrosa Ranch and East Chacon areas of western South Texas, Early Archaic sites tend to be found in "water-proximate" areas, such as high terraces overlooking major creeks (see Hester 1978; McGraw and Knepper 1983). Almost no direct evidence of subsistence is available for the Early Archaic period, largely because preservation of faunal material and plant macro- and micro-remains is poor in the Rio Grande Plains (Hester 1995:439).

### **Middle Archaic (5000–2400 BP)**

Diagnostic artifacts for this period include Pedernales, Langtry, Kinney, and Bulverde points. Tortugas, Morhiss, and Lange points appear late in the period, after 2950 BP (Black 1989). In addition, distally beveled tools, tubular pipes, and triangular bifaces, which persist throughout the Archaic, are common (Black 1989; Hester 1995). Although not as numerous or as large as those found in Central Texas, accumulations of burned rock containing artifacts datable to this interval are found in the northern parts of the region. Manos and metates are very common from this period, into the Late Archaic. In general, however, the evidence points to less intensification of vegetal resource utilization in South Texas than is seen in Central Texas.

During the Middle Archaic, open campsites occur inland on knolls and bluffs along stream channels and tributaries, and along estuary bays in the Coastal Bend region (Black 1989; Story 1985). In the later Middle Archaic period, sites are also commonly located on floodplains, low terraces, and natural levees in addition to the upland settings (Hester 1995).

Subsistence remains from Middle Archaic sites indicate the use of nuts and mesquite beans, acacia, hackberry, and oak (Hall et al. 1986). Freshwater mussels, land snails, deer, and small mammal remains are common, as are littoral resources along the coast (Black 1989). Sites with large accumulations of burned rock are common in Central Texas (Black 1989; Hester 1995). Plant remains found in association with burned-rock accumulations indicate that these middens were formed during the processing of plant resources. This indicates an increased reliance on plant foods requiring intensive processing (Black 1989).

The first large cemeteries appear during the later part of the Middle Archaic, at sites like Loma Sandia (Taylor and Highley 1995) and Morhiss (Campbell 1976). It has been

suggested that these cemeteries reflect an increase in population and/or territorial restriction (Black 1989; Hester 1995; Story 1985).

### **Late Archaic (ca. 2400–1150 BP)**

The Late Archaic in South Texas is characterized by the presence of Shumla, Ensor, Montell, and Marcos points and Olmos bifaces (Hester 1995:441). In and near Webb County, Desmuke, Matamoros, and Catan points are found. Large (15–20 cm long), thin, triangular bifaces made of non-local cherts are another Late Archaic tool found in the Rio Grande Plains area (Hester 1995:442). Corner-tang bifaces and small distally beveled tools called Nueces scrapers are common (Black 1989). Olmos bifaces, small triangular gouge-like tools (Hester 1995), and manos and grinding slabs also are common in Late Archaic sites in South Texas.

Late Archaic sites are usually located near modern stream channels and occur in all topographic settings (Black 1989; Hester 1995). Sloughs or oxbow lake margins were also preferred site locations (Kelly 1983; McGraw and Knepper 1983). Subsistence was broadly based, with a wide range of animal bone present in sites, along with large amounts of freshwater mussel shell in some sites (Hester 1995:442). There seems to have been a greater reliance on a broad spectrum of plant resources, with small animals (e.g., rodents, rabbits, turtles, fish, lizards, and snakes) and land snails also of importance (Black 1989). While there appears to be a decline in the accumulation of large burned rock deposits in Central Texas (Black 1989), extensive deposits of fire-cracked rocks continue to occur in Late Archaic sites in South Texas (Hester 1995).

During the Late Archaic, there is a continued use of large cemeteries first seen in the Middle Archaic. Examples include the Ernest Witte, Leonard K., and Morhiss sites, as well as many others (Perttula 1997; Taylor and Highley 1995). There is an increase in the number and variety of grave inclusions found in the later Archaic burials at these cemeteries (Black 1989; Hall 1981, 1984; Hester 1995).

### **Late Prehistoric (ca. 1150–350 BP)**

At about 1150 BP there is a distinctive shift in artifact assemblages across Central and South Texas: the use of the atlatl is replaced by the bow and arrow. This change is not apparent along the coastal regions until about 750 BP. This early period of the Late Prehistoric in Central Texas is termed the Austin Phase (1150–600 BP). During this period, the

first evidence of bone-tempered pottery is found in association with expanding stem arrow points. Edwards, Granbury, and Scallorn arrow points are commonly found on early Late Prehistoric sites; the latter type, in particular, is found over most of the state. Edwards points have been found largely in the Rio Grande Plains, although they are occasionally seen outside this area (Prewitt 1995:102). The relationship of this point to Scallorn points and other Austin Phase arrow points is still being addressed (Hester 1995:443).

At about 600 BP is another distinct change in lithic tool assemblages: arrow point forms shift from expanding stem types to contracting stem types such as Perdiz and Clifton (Black 1989). This latter part of the Late Prehistoric in Central and South Texas is termed the Toyah Phase. It is characterized by Perdiz and Clifton arrow points, often found in association with bison bones or kill sites, beveled bifaces, drills, small scrapers, a flake-blade lithic technology, and bone-tempered Leon Plain ceramics (Hall 1981; Prewitt 1981; Skelton 1977). Tools made from bison bone are also common. The sharp increase in frequency of bison bone in Toyah sites is distinctive, suggesting that the importance of hunting large game increased, though small mammals, riverine species, mussels, and land snails continue to be important contributions to the diet (Hall 1981; Hester and Hill 1975; Prewitt 1981; Skelton 1977).

## Previous Investigations

Due to the project area's proximity to the site of Mission Concepción, numerous research projects have been conducted in the general vicinity. During 1971 and 1972, the Texas State Historical Survey Committee (now the Texas Historical Commission [THC]) sponsored the first archaeological project at the mission. The purpose was to examine the foundations of the church walls to determine if the deterioration of the lower walls of the church was due to problems with the foundations. The second part of the project was to relocate the granary and the west wall of the Colonial-period compound (Scurlock and Fox 1977:1). The project determined that the foundations of the church appeared dry and solid, and located a series of wall remnants. Numerous Colonial, as well as nineteenth- and twentieth-century middens were documented. The possible remains of acequias were encountered in at least two areas, Test Pits 14 and 17 (Scurlock and Fox 1977:43), and Test Pit 50 (Scurlock and Fox 1977:Figure 13). Much of the south and west wall areas were found to be seriously disturbed by bulldozing that occurred in the 1950s.

Beginning in December 1980, with a second field phase concluding in June of the following year, CAR continued the search for the original walls of the mission. This report has only recently been published (Ivey and Fox 1999). These excavations confirmed that the southern part of the west wall and most of the south wall were badly disturbed, while the east and north wall foundations, along with remains of associated rooms, were relatively undisturbed (Ivey and Fox 1999:9, Figure 4). This project also located some of the foundations of the original convento, built before the current building (Ivey and Fox 1999:15). The remains of two sections of acequia were found, one just north of the church and the other near the south wall near the section discovered by Scurlock and Fox (1977). Portions of the east and north walls were also recorded.

In 1986 CAR archaeologists tested an area south of the church in order to determine the best route for a drainage pipe needed to end occasional flooding of the convento. Two excavation blocks (one 12 m<sup>2</sup> and the other 4 m<sup>2</sup>) were placed south of the convento. These excavations showed that although the remains of several walls were present, the artifacts recovered indicated that considerable disturbance had taken place in the area (Fox 1988:20).

Plans to realign Mission Road outside the mission compound led to further excavations by CAR in 1987. This project was intended to locate any important features, especially acequias, that might be impacted when the new Mission Road was constructed west of the mission, outside the original mission compound (Labadie 1989). Three backhoe trenches and a series of 11 test trenches located the remains of an acequia, but otherwise showed that the area west of the mission had been seriously disturbed in the past. The alignment of the acequia west of the mission suggests it trends slightly west of the current proposed development of St. P.J.'s. CAR personnel also monitored the construction of an electrical conduit trench and a condensation line for an air conditioning system. The electrical conduit trench crossed one wall, presumably part of the foundation of the first convento (Fox 1989).

In 1990 further testing of the area between the old Mission Road and the new realignment located a few remains of the west wall of the mission compound, and otherwise documented extensive disturbance of the west wall area. The presumed location of the northwest corner of the mission compound had been disturbed by utility trenches (Brown et al. 1994). An additional test trench was later excavated to locate the north wall of the church near the northwest corner.

Extrapolation from the wall found in this trench confirmed that the northwest corner of the church had been destroyed (Fox 1992).

During 1998 and 1999, CAR investigated a large number of animal bones that were unearthed by a construction crew. The feature was determined to be a section of an acequia that had been filled with construction debris and trash, including large numbers of animal bones, during the Spanish Colonial period (Meissner 2001). Subsequent monitoring of other underground utility work in the area resulted in the location of a Colonial-period wall, located southeast of the mission Visitors' Center, which may have been part of the original south wall of the mission compound.

Most recently, CAR has conducted archaeological field schools during the 2002 and 2003 field seasons within the known bounds of the mission. These excavations were conducted primarily to further define structural walls associated with the mission proper. While several structural remnants were encountered, the results of these investigations have yet to be reported.

## Chapter 4: Methodology

This chapter details the various methods used to investigate the project area. Each general step of the process is presented and includes sections concerning the initial literature review, field methods, and laboratory methods.

### Literature Review

The archaeological research commenced with a comprehensive review of all available archaeological reports and databases to identify and characterize all archaeological sites known to occur in the general vicinity of the project area. At least in part, the compilation of the known prehistoric and historic sites within and in the vicinity of the project area is based on the Texas Archeological Sites Atlas, Texas Historic Sites Atlas, and THC map files that contain information on all sites recorded within each county in the state. The literature and archival review also included United States Geological Survey (USGS) topographic maps and the USDA Soil Conservation Service's Soil Survey of Bexar County (Taylor et al. 1991). Recent project-specific aerial photographs were assembled for the delimitation of the project area in an ArcView® database. This baseline was used to define the precise limits of the project area.

### Field Methods

The survey consisted of a 100 percent pedestrian survey of the proposed project area (3.17 acres). A crew of three archaeologists traversed the project area along 30-meter transects. Aerial photographs with clearly marked transects and hand-held compasses were used to orient crew members along their routes. The project area was divided into the previously mentioned (Chapter 1) three construction tasks that aided orientation and areal coverage of shovel tests.

For the purpose of this survey, sites were defined as locations having at least five artifacts within a 30 m<sup>2</sup> area, or as a location containing a single cultural feature such as a hearth. All other artifacts were to be classified as isolated occurrences. Shovel tests were conducted in accordance with the Texas Historical Commission archaeological survey standards at an average rate of two (2) shovel tests for every one (1) acre, resulting in a minimum of seven shovel tests within the project area.

The indication of subsurface disturbances, most notably in the western and northwestern portions of the project area, precluded consistent shovel test coverage in those areas. Specifically, the use of those areas as an unimproved parking lot and/or equipment storage locale has modified the soils to an extent that no significant cultural deposits would remain intact.

Shovel tests were 30 cm in diameter and were excavated to a maximum depth of 70 cm below surface, unless otherwise prevented from reaching this depth. They were excavated in levels not exceeding 10 cm in thickness. Deposits from these tests were screened through ¼-inch hardware cloth, all artifacts were collected, and observations on the shovel tests were recorded on standardized forms. When evidence of cultural activity was encountered in a shovel test, additional shovel tests were excavated to define the extent of the distribution. A total of 11 shovel tests was dug to explore such distributions. By the end of the project, a total of 18 shovel tests was excavated within the project area.

### Laboratory Methods

All cultural materials recovered were inventoried at the CAR laboratory. All artifacts recovered were identified and analyzed. Processing of recovered artifacts began with washing and sorting into appropriate categories (e.g., debitage, tools). The catalog was entered into an Excel® spreadsheet.

All cultural material collected during the survey was prepared in accordance with current state and/or federal regulations. Artifacts processed in the CAR laboratory were stored in archival-quality bags. Acid-free labels were placed in all artifact bags. Each label contains a provenience or corresponding lot number.

Subsequent to proper analyses and/or quantification, artifacts possessing little scientific value were discarded pursuant to Chapter 26.27(g)(2) of the Texas Administrative Code. Artifact classes discarded specific to this project included burned rock, mechanically impacted chert, and snail shell. In all instances discarded materials were documented and their counts included in this report and curation



documentation. Discarded materials were disposed of in a manner consistent with suitable disposal procedures.

Field notes, forms, and drawings were placed in archivally stable folders. Documents and forms were printed on acid-free paper. A copy of the survey report and all computer disks pertaining to the investigations were curated with the field notes and documents. After completion of the project, all cultural materials and records were curated at the CAR permanent storage facility.

## Chapter 5: Results

This chapter presents the results of investigations for the St. PJ's project. Similar to the previous chapter on methodology, this chapter is subdivided into sections reporting on the results of the initial literature review and the fieldwork.

### Literature Review

Numerous sources were consulted for the production of this report. Extensive literature covering the archaeological background of previous investigations and previously recorded archaeological sites were reviewed to provide a background for the types of cultural material that may be encountered in the project area. In addition, numerous cartographic resources were examined to determine the extent of historic activity within the area.

Several early (late-1800s through early-1900s) maps depict portions of the St. PJ's campus, albeit only ephemerally. The majority of these maps simply denote the property as "orphanage" and provide no detail as to the structures contained on the property. An early photograph of the campus grounds is reproduced here as Figure 5-1. The photo was taken facing west depicting the façade of the main structure. Of note in this photo is the apparent dormitory extending to the south of the main building. Also visible is another building of similar size located to the north of the main structure.

An undated Tobin® aerial photograph, probably from the late 1960s, shows that the location of the original orphanage remained unchanged, along with the large structure to the north (Figure 5-2). The dormitory to the south, however, has been demolished and an open field occupies its former location. Also visible in this photograph is a swimming pool located farther south of the main structure. Several unimproved roads are visible crisscrossing the campus.

In comparison with the current layout of the St. PJ's campus, it is apparent that much has changed in the previous 40 years. Figure 5-3 presents the 1960s Tobin® map with the current footprint superimposed.

The dormitory to the north of the main structure has since been demolished and replaced with a modern dormitory facility. Similarly, to the south of the main structure, an identical dormitory has been constructed. This southern dormitory likely occupies at least a portion of the south dormitory depicted in Figure 5-1. The pool located along the southern portion of the property has been fenced and subsequently abandoned and in-filled. Fences have similarly enclosed the entirety of the campus, and the locations of the unimproved roads have been altered to accommodate the now-enclosed campus grounds.



Figure 5-1. *Early photograph of St. PJ's depicting dormitory locations.*  
(Source: <http://www.stpjhome.org/index.html>)



Figure 5-2. Tobin® aerial photograph of the campus probably taken during the late 1960s.  
(Map on file at CAR.)



Figure 5-3. Overlay of 1960s Tobin® aerial with the modern footprint of St. PJ's campus.

## Fieldwork

A total of 18 shovel tests was excavated within the area to be impacted by the current phase of St. PJ's expansion. Figure 5-4 depicts the distribution of shovel tests across the project area. Of note in the figure is the lack of shovel tests in the northwestern portion of the project area. While the entirety of the area to be impacted by the current phase of construction was subject to pedestrian survey, this northwestern portion was not subject to shovel testing. This decision was made based on the apparent disturbance already present in that area. Moreover, this portion of the project area is currently used for parking and storage and appears to receive a relatively high volume of activity.

The remainder of the project area was subject to adequate coverage of shovel tests. The rate of shovel tests is well within the Minimum Survey Standards for Project Areas of 200 Acres or Less, espoused by the THC. Under these guidelines, the THC proposes a density of two shovel tests per acre (2:1) for project areas of three to ten acres in size. Excavation of 18 shovel tests for the current project results in a shovel test density to project area size of roughly 5.7:1.

A single archaeological site (41BX1570) was encountered and recorded during the field efforts. The site occurs along the southern property boundary separating St. PJ's and Seton Home. Within the St. PJ's property, the site covers an area approximately 60 meters long and 45 meters wide. Although

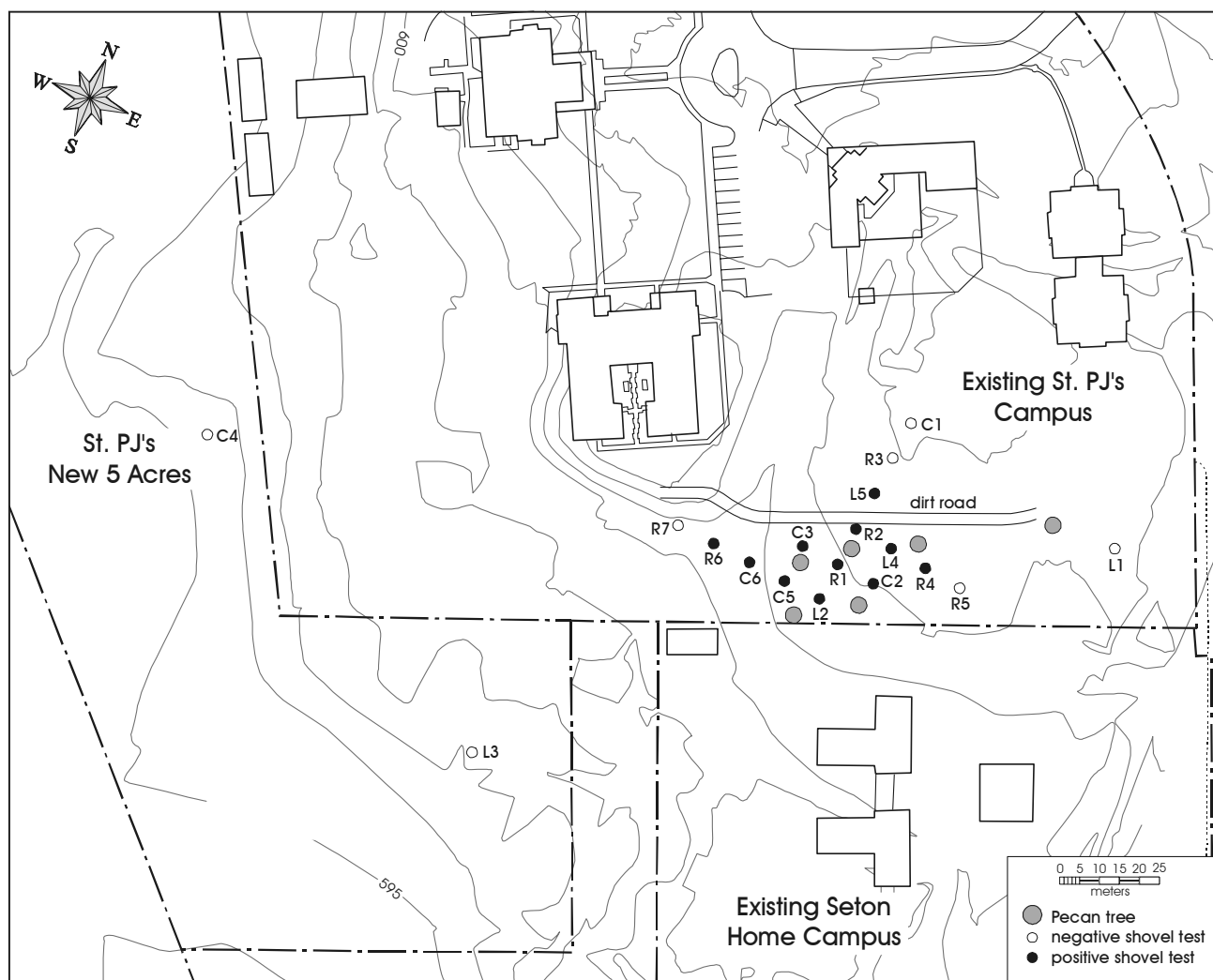

Figure 5-4. Distribution of shovel tests excavated during September 2003.

not tested, the Seton Home property likely includes a considerable portion of the newly recorded site.

Soils encountered in the 41BX1570 shovel tests included loam to clay loams. Various naturally occurring erosional limestone gravels were encountered in the upper portion of the profile, with larger limestone gravels and small cobbles occurring in the lower portion of the profile. No indication of significant disturbance was noted in the strata encountered during excavation of the shovel tests.

Eleven shovel tests were excavated within the site bounds, with a total recovery of 104 modern and prehistoric artifacts (Appendix A). Included in this total are 62 burned chert fragments, 30 pieces of lithic debitage, five charcoal samples, four mechanical flakes (modern), two lithic tools, and one wire nail (modern). To examine the distribution of cultural material, only those items confidently assigned to the prehistoric period are included in the following analysis. The modern items and their relationship to the prehistoric materials will be addressed afterward.

Figures 5-5 and 5-6 depict the vertical distribution of prehistoric artifacts (burned chert and debitage) recovered from 41BX1570. Figure 5-5 shows the distribution by count, while Figure 5-6 shows the distribution by percentage. Tables 5-1 and 5-2 contain the corresponding tabular data.

A peak in the density of both prehistoric artifact classes is evident in Level 3 (20–30 cm [8–12 in.] below surface). For lithic debitage, the counts drop slightly in Levels 4 and 5 and by Level 6 (50–60 cm [20–24 in.] below surface), the counts drop significantly. For burned chert, a gradual decrease in density occurs throughout the remainder of the vertical column. Of note in regard to the vertical distribution of prehistoric cultural material, though, is the recovery of a unifacially retouched lithic artifact (uniface) in Level 6 and a bifacially retouched lithic artifact (biface) in Level 7 (60–70 cm [24–28 in.] below surface).

Table 5-3 presents the horizontal distribution of prehistoric artifacts. The greatest amount of material was recovered from four of the shovel tests (C5, R1, R2, and R4). In reference to Figure 5-4, these four shovel tests occur within the south-central portion of the site.

Although not collected, abundant burned limestone was encountered in each of the shovel tests excavated within the site bounds. The density of burned limestone was roughly proportional to the density of burned chert, as depicted in Figures 5-5 and 5-6. The size of burned limestone ranged from small (10 mm [0.4 in.] in diameter) to moderate (120 mm [5 in.] in diameter), with various stages of thermal alteration. The burned limestone did not occur in clusters indicative of *in situ* cultural features.

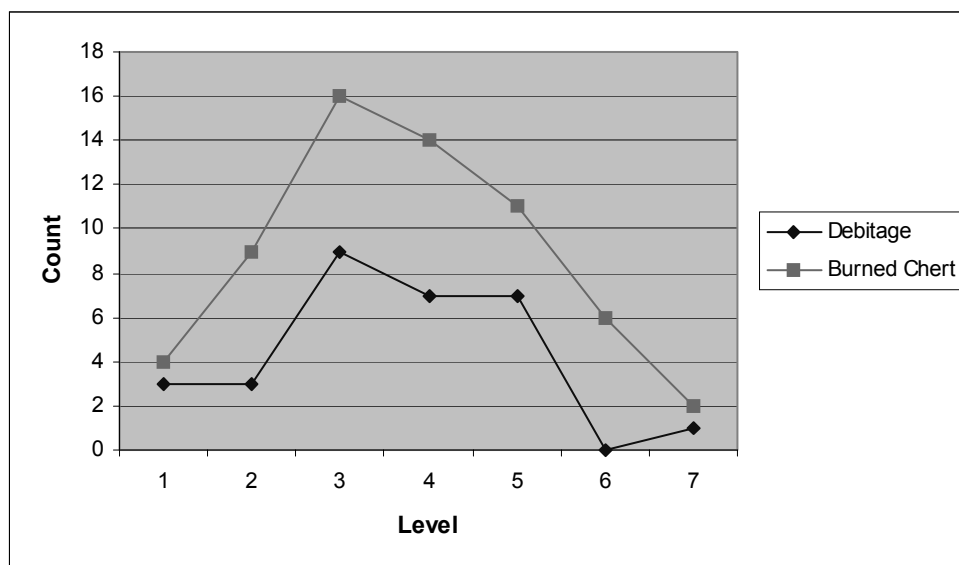

Figure 5-5. Vertical distribution of burned chert and debitage by count.

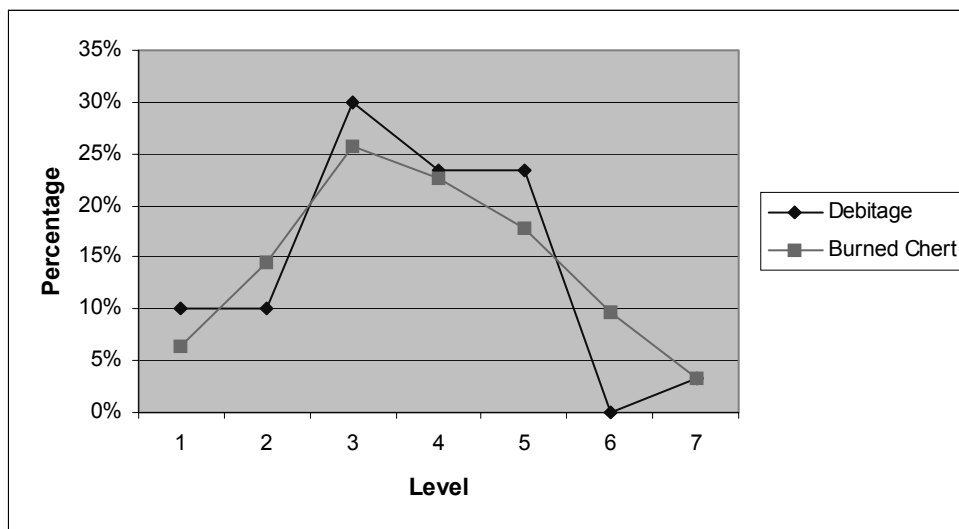

Figure 5-6. Vertical distribution of burned chert and debitage by percentage.

Table 5-1. Vertical distribution by count.

Level	Debitage	Burned Chert	Total
1	3	4	7
2	3	9	12
3	9	16	25
4	7	14	21
5	7	11	18
6	0	6	6
7	1	2	3
Total	30	62	92

Table 5-2. Vertical distribution by percent.

Level	Debitage	Burned Chert
1	10%	6%
2	10%	15%
3	30%	26%
4	23%	23%
5	23%	18%
6	0%	10%
7	3%	3%

Table 5-3. Horizontal distribution of prehistoric artifacts.

ST	Burned Rock	Debitage	Tool	Total	%
C2	1	0		1	1%
C3	4	3		7	7%
C5	14	8		22	23%
L2	5	3		8	9%
L4	2	0		2	2%
L5	1	1		2	2%
R1	12	7		19	20%
R2	14	3	1	18	19%
R4	8	5		13	14%
R6	1	0	1	2	2%
Total	62	30	2	94	100%

Five modern artifacts were recovered during the survey at various depths across the site. The recovery of two of the five modern artifacts occurred within the first level (Level 1; 0–10 cm [0–4 in.] below surface). The presence of these materials at this depth is consistent with typical deposition on a site currently occupied. However, the recovery of the balance of modern artifacts (n=3) occurred at a depth that would normally preclude typical deposition. Specifically, three mechanically produced lithic flakes were recovered from 30–60 cm (12–24 in.) below ground surface.

Five charcoal samples deemed adequate for potential radiometric dating were recovered from the upper four levels of excavation across the site. While moderate charcoal flecking was encountered among the abundant burned chert and burned limestone, no significant samples were noted below Level 4.

## Chapter 6: Summary

This report has presented the results of the archaeological investigations for the first stage of the proposed St. Peter-St. Joseph Children's Home development and expansion project. A total of 18 shovel tests excavated across the areas to be impacted by the first stage of construction resulted in the location of one previously unidentified prehistoric archaeological site (41BX1570). A relatively high density of prehistoric cultural material was encountered across the delimited site bounds. In addition to lithic debitage, burned limestone, burned chert, charcoal, and two lithic tools were recovered. Modern artifacts, in the form of mechanically produced lithic flakes, were recovered along with these prehistoric artifacts to a depth of 70 centimeters (28 inches) below ground surface.

It is the recovery of these modern artifacts at such a depth that warranted a further look at the history of construction activities at St. PJ's. Comparison of aerial photographs, historic photographs, and various maps reveal a history of significant disturbances within the current grounds of the campus. It is likely that these disturbances would have impacted subsurface deposits as suggested by mechanically derived chert flakes.

The landform atop which the campus sits is a terrace of the San Antonio River. In review of cartographic sources, it is possible that the river was at one time adjacent to this landform. The combination of proximity to potable water and situation atop a terrace landform comprised of well-drained loam and clay loam deposits would have made an attractive occupation site for prehistoric inhabitants. It is likely that this location for the adjacent Mission Concepción was equally attractive for Spanish Colonial settlers as well.

In conclusion, the current archaeological survey has defined the location of a prehistoric site of unknown temporal affiliation (41BX1570). During analysis of the artifact assemblage recovered from this site, however, it is apparent that significant subsurface disturbance has compromised the stratigraphic integrity of the deposits associated with this prehistoric site. It is therefore the recommendation of the Center for Archaeological Research that site 41BX1570 is not eligible for inclusion on the National Register of Historic Places nor for listing as a State Archeological Landmark. As such, no further cultural resources investigations are recommended for this portion of the St. PJ's project and construction should be allowed to proceed as planned.



## References Cited

Black, S. L.

- 1989 Central Texas Plateau Prairie. In *From the Gulf Coast to the Rio Grande: Human Adaptation in Central, South and Lower Pecos Texas*, by T. R. Hester, S. L. Black, D. G. Steele, B. W. Olive, A. A. Fox, K. J. Reinhard, and L. C. Bement, pp. 17–38. Research Series No. 33. Arkansas Archeological Survey, Fayetteville.

Blair, W. F.

- 1950 The Biotic Provinces of Texas. *Texas Journal of Science* 2(1):93–117.

Brown, K. M.

- 1987 Early Occupation at Berger Bluff, Goliad County, Texas. *Current Research in the Pleistocene* 4:3–5.

Brown, M. J., A. A. Fox, and B. A. Meissner

- 1994 *Archaeological Testing for the Mission Road Realignment Project, Phase II, at Mission Concepción, San Antonio, Texas*. Archaeological Survey Report, No. 222. Center for Archaeological Research, The University of Texas at San Antonio.

Campbell, T. N.

- 1976 Archaeological Investigations at the Morhiss Site, Victoria County, Texas, 1932–1940. In *An Archaeological Survey of Coleta Creek, Victoria and Goliad Counties, Texas*, by A. A. Fox and T. R. Hester, pp. 81–85. Archaeological Survey Report, No. 18. Center for Archaeological Research, The University of Texas at San Antonio.

Collins, M. B.

- 1995 Forty Years of Archeology in Texas. *Bulletin of the Texas Archeological Society* 66:361–400.  
1998 *Wilson-Leonard: An 11,000-year Archeological Record of Hunter-Gatherers in Central Texas*. Studies in Archeology, Report No. 31. Texas Archeological Research Laboratory, The University of Texas at Austin. Archeology Studies Program, Report No. 10. Environmental Affairs Division, Texas Department of Transportation, Austin.

Fenneman, N.

- 1931 *Physiography of the Western United States*. McGraw Hill, New York.

Fox, A. A.

- 1988 *Archaeological Excavations at Mission Concepción, Fall of 1986*. Archaeological Survey Report, No. 172. Center for Archaeological Research, The University of Texas at San Antonio.  
1989 *Monitoring of Utility Trenches at Mission Concepción, San Antonio, Texas, 1988*. Archaeological Survey Report, No. 180. Center for Archaeological Research, The University of Texas at San Antonio.  
1992 *Archaeological Investigation to Locate the Northwest Corner of Mission Concepción, San Antonio, Bexar County, Texas*. Archaeological Survey Report, No. 212. Center for Archaeological Research, The University of Texas at San Antonio.

Hall, G. D.

- 1981 *Allens Creek: A Study in the Cultural Prehistory of the Brazos River Valley, Texas*. Research Report 61. Texas Archeological Survey, The University of Texas at Austin.  
1984 Archaeology of the Texas Central Coastal Plain. Unpublished manuscript on file, Center for Archaeological Research, The University of Texas at San Antonio.

Hall, G. D., T. R. Hester, and S. L. Black (editors)

- 1986 *The Prehistoric Sites at Choke Canyon Reservoir, Southern Texas: Results of the Phase II Archaeological Investigations*. Choke Canyon Series, No. 10. Center for Archaeological Research, The University of Texas at San Antonio.

Hester, T. R.

- 1978 *Background to the Archaeology of Chaparrosa Ranch, Southern Texas. Volume I: Studies in the Archaeology of Chaparrosa Ranch*. Special Report, No. 6. Center for Archaeological Research, The University of Texas at San Antonio.
- 1995 The Prehistory of South Texas. *Bulletin of the Texas Archeological Society* 66:427–459.

Hester, T. R., and T. C. Hill

- 1975 *Some Aspects of Late Prehistoric and Protohistoric Archaeology in Southern Texas*. Special Report, No. 1. Center for Archaeological Research, The University of Texas at San Antonio.

Ivey, J. E., and A. A. Fox

- 1999 *Archaeological Investigations at Mission Concepción and Mission Parkway*. Archaeological Survey Report, No. 114. Center for Archaeological Research, The University of Texas at San Antonio.

Kelly, R. L.

- 1983 Hunter-Gatherer Mobility Strategies. *Journal of Anthropological Research* 39:277–306.

Labadie, J. H.

- 1989 *Archaeological and Historical Investigations for the Mission Road Realignment Project, San Antonio, Texas*. Archaeological Survey Report, No. 173. Center for Archaeological Research, The University of Texas at San Antonio.

McGraw, A. J., and D. Knepper

- 1983 *The East Chacon Project: 11,000 Years of Prehistory along the Upper Nueces River, Southern Texas*. Archaeological Survey Report, No. 125. Center for Archaeological Research, The University of Texas at San Antonio.

Meissner, B. A.

- 2001 Mission Concepcion: Introduction. In *Archaeological Investigations at Four San Antonio Missions: Mission Trails Underground Conversion Project*, edited by C. L. Tennis, pp. 63–65. Archaeological Survey Report, No. 297. Center for Archaeological Research, The University of Texas at San Antonio.

Perttula, T. K.

- 1997 Hunter-Gatherer Mortuary Practices. In *Archaeology of the Rio Grande and Central Coastal Plains, Texas: A Planning Document*, pp. 7.1–7.51, edited by S. A. Tomka, T. K. Perttula, and R. J. Hard. Archaeological Survey Report, No. 266 (Draft). Manuscript on file Center for Archaeological Research, The University of Texas at San Antonio.

Prewitt, E. R.

- 1981 Culture Chronology in Central Texas. *Bulletin of the Texas Archeological Society* 52:65–89.
- 1995 Distributions of Typed Projectile Points in Texas. *Bulletin of the Texas Archeological Society* 66:83–173.

Scurlock, D., and D. E. Fox

- 1977 *An Archeological Investigation of Mission Concepción, San Antonio, Texas*. Office of the State Archeologist, Texas Historical Commission, Austin.

Skelton, D. W.

- 1977 *Archeological Investigations at the Fayette Power Project, Fayette County, Texas*. Research Report 60. Texas Archeological Survey, The University of Texas at Austin.

Sollberger, J. B., and T. R. Hester

- 1972 The Strohacker Site: A Review of Pre-Archaic Manifestations in Texas. *Plains Anthropologist* 17(58):326–344.

Story, D. A.

- 1985 Adaptive Strategies of Archaic Cultures of the West Gulf Coastal Plain. In *Prehistoric Food Production in North America*, edited by R. I. Ford, pp. 19–56. Anthropological Papers No. 75. Museum of Anthropology, University of Michigan, Ann Arbor.

Tankersley, K. B., and B. L. Isaac

- 1990 *Early Paleoindian Economies of North America*. JAI Press, Greenwich, Connecticut.

Taylor, A. J., and C. L. Highley

- 1995 *Archaeological Investigations at the Loma Sandia Site (41LK28): A Prehistoric Campsite in Live Oak County, Texas*, 2 volumes. Studies in Archeology No. 20. Texas Archeological Research Laboratory, The University of Texas at Austin.

Taylor, F. B., R. B. Hailey, and D. L. Richmond

- 1991 *Soil Survey of Bexar County, Texas*. United States Department of Agriculture, Soil Conservation Service, Washington, D.C.

Tomka, S. A., T. K. Perttula, and R. J. Hard

- 1997 Archaeology of the Rio Grande and Central Coastal Plains, Texas: A Planning Document. Archaeological Survey Report, No. 266 (Draft). Manuscript on file Center for Archaeological Research, The University of Texas at San Antonio.

Vierra, B. J.

- 1998 *41MV120: A Stratified Late Archaic Site in Maverick County, Texas*. Archaeological Survey Report, No. 251, Center for Archaeological Research, The University of Texas at San Antonio; Archeology Studies Program, Report No. 7, Environmental Affairs Division, Texas Department of Transportation, Austin.

# Appendix A

## Artifact Catalog

Table A-1. Artifact catalog of September 2003 shovel test excavations at St. PJ's.

Cat. No	Field Sack #	Shovel Test	Level	Depth (cmbs)	Class	Description	Ct	Wt (g)	Comments
1-001	1	R1	3	20-30	Debitage		4		
1-002	1	R1	3	20-30	Burned Rock	Chert	6		
1-003	1	R1	3	20-30	Burned Rock	Limestone	6		
2-001	2	R1	4	30-40	Debitage		2		
2-002	2	R1	4	30-40	Burned Rock		1		
2-003	2	R1	4	30-40	Mechanical		1		discarded
3-001	3	R1	5	40-50	Debitage		1		
3-002	3	R1	5	40-50	Burned Rock	Chert	2		
3-003	3	R1	5	40-50	Mechanical		1		discarded
4	4	R1	6	50-60	Burned Rock	Chert	2		
5	5	R1	7	60-70	Burned Rock	Chert	1		
6	6	C3	1	0-10	Debitage		2		
7	7	C3	2	10-20	Burned Rock	Chert	1		
8	8	C3	4	30-40	Burned Rock	Chert	3		
9	9	C3	5	40-50	Debitage		1		
10	10	C2	2	10-20	Burned Rock	Chert	1		
11	11	R2	2	10-20	Burned Rock	Chert	2		
12	12	R2	3	20-30	Burned Rock	Chert	1		
13-001	13	L2	3	20-30	Debitage		1		
13-002	13	L2	3	20-30	Burned Rock	Chert	2		
14-001	14	L2	4	30-40	Debitage		2		
14-002	14	L2	4	30-40	Burned Rock	Chert	2		
15	15	L2	6	50-60	Burned Rock	Chert	1		
16	16	L3	4	30-40	Charcoal		1	0.01	
17	17	L4	1	0-10	Mechanical		1		discarded
18	18	L4	3	20-30	Burned Rock	Chert	2		heat spalls
19-001	19	R2	4	30-40	Debitage		3		
19-002	19	R2	4	30-40	Burned Rock	Chert	7		
20	20	R2	5	40-50	Burned Rock	Chert	1		
21	21	R2	6	50-60	Burned Rock	Chert	2		
22-001	22	R2	7	60-70	Tool	biface	1		
22-002	22	R2	7	60-70	Burned Rock	Chert	1		heat spall
23	24	L5	4	30-40	Burned Rock	Chert	1		heat spall
24	25	L5	7	60-75	Debitage		1		
25-001	27	C6	1	0-10	Metal	round nail	1		
25-002	27	C6	1	0-10	Charcoal		1	11.6	
26-001	28	C5	1	0-10	Debitage		1		
26-002	28	C5	1	0-10	Burned Rock	Chert	4		
26-003	28	C5	1	0-10	Charcoal		1	6.0	
27	29	C5	2	10-20	Charcoal		1	0.2	
28-001	30	C5	3	20-30	Debitage		3		
28-002	30	C5	3	20-30	Burned Rock	Chert	4		
28-003	30	C5	3	20-30	Charcoal		1	0.5	
29-001	31	C5	5	40-50	Debitage		4		
29-002	31	C5	5	40-50	Burned Rock	Chert	6		
30-001	32	R4	2	10-20	Debitage		3		
30-002	32	R4	2	10-20	Burned Rock	Chert	5		
31-001	33	R4	3	20-30	Debitage		1		
31-002	33	R4	3	20-30	Burned Rock	Chert	1		
32-001	34	R4	5	40-50	Debitage		1		
32-002	34	R4	5	40-50	Burned Rock	Chert	2		
33-001	35	R6	6	50-60	Tool	Uniface	1		
33-002	35	R6	6	50-60	Burned Rock	Chert	1		heat spall
33-003	35	R6	6	50-60	Mechanical		1		discarded